

Current part is item (1) on diagram. Available at www.oshkosequipment.com

(1) (a) FIG. NO.	(2) (b) ITEM NO.	(3) SMR CODE	(3) NATIONAL STOCK NUMBER	(4) PART NUMBER	(5) FSCM	(6) DESCRIPTION USABLE ON CODE	(7) U/M	(8) INC IN UNIT
						0613-HULL OR CHASSIS WIRING HARNESS (CONT'D)		
91	5	PAOZZ	5340-00-993-6207	MS21333-99	96906	CLAMP, LOOP	EA	4
91	6	PAOZZ	2590-00-394-9720	11609718	19207	HARNES: REAR SIDE CLEARANCE LIGHTS (M756A2)	EA	1
91	7	PAOZZ	5935-00-900-6281	MS27147-1	96906	ADAPTER, CONNECTOR: REAR SIDE CLEARANCE LIGHTS (M756A2)	EA	2
91	8	PAOZZ	5325-00-276-6056	MS35489-106	96906	GROMMET, RUBBER: FLOODLIGHT, REAR SIDE AND REAR END HARNES (M756A2)	EA	7
91	9	PAOZZ	2590-00-399-5297	11609719	19207	HARNES: REAR CLEARANCE LIGHTS (M56A2)	EA	1
91	10	PAOZZ	5310-00-934-9758	MS35649-202	96906	NUT, PLAIN, HEXAGON: BODY CLEARANCE LIGHTS (M756A2)	EA	72
91	11	PAOZZ	5310-00-596-7691	MS35335-32	96906	WASHER, LOCK: BODY CLEARANCE (M756A2)	EA	72
91	NI	PAOZZ	2590-00-832-9976	8722943	19207	CLIP, CONNECTOR: WIRING HARNESS TO BODY CLEARANCE LIGHTS (M756A2)	EA	4
91	NI	PAOZZ	5305-00-068-0506	MS90726-6	96906	SCREW, CAP, HEXAGON HEAD: CLIP AND CLAMPS AT BODY SIDE CLEARANCE LIGHTS AND HARNESS (M756A2)	EA	8
91	NI	PAOZZ	5310-00-959-7600	MS51922-5	96906	NUT, SELF-LOCKING: CLIP AND CLAMPS AT BODY SIDE CLEARANCE LIGHTS AND HARNES (M756A1)	EA	8
91	NI	PAOZZ	5340-00-523-5996	7373268	19207	CLAMP, LOOP: HARNESS TO BODY SIDE CLEARANCE LIGHTS (M756A2)	EA	2
91	NI	PAOZZ	2590-00-388-9977	11609717	19207	HARNES: FRONT BODY SIDE CLEARANCE LIGHTS (M756A2)	EA	1
91	NI	PAOZZ	5310-00-947-6980	MS45904-71	96906	WASHER, LOCK: CLAMP FOR FLOODLIGHT HARNES (M756A2)	EA	1
91	NI	PAOZZ	5330-00-514-4462	7716716	19207	RETAINER, PACKING (M756A2)	EA	2
91	NI	PAOZZ	5340-00-964-5267	MS21333-120	96906	CLAMP, LOOP: HARNESS TO REAR CLEARANCE LIGHTS (M756A2)	EA	2
91	NI	PAOZZ	2590-00-388-9980	11609716	19207	HARNES ASSEMBLY: FLOOD AND CLEARANCE LIGHTS	EA	1
91	NI	PAOZZ	6220-00-577-3434	MS35423-1	96906	LIGHT, MARKER: FRONT, CLEARANCE, SERVICE	EA	5
91	NI	PAOZZ	6220-00-577-3435	MS35424-1	96906	LIGHT, MARKER: SIDE, CLEARANCE, BLACKOUT	EA	2
91	NI	PAOZZ	5325-00-432-7380	11640443	19207	GROMMET	EA	2
92	1	PAOZZ	5310-00-959-7600	MS51922-5	96906	NUT, SELF-LOCKING	EA	4
92	2	PAOZZ	5310-00-889-2528	MS45904-68	96906	WASHER, LOCK	EA	4
92	3	PAOZZ	5305-00-068-0507	MS90726-7	96906	SCREW, CAP, HEXAGON HEAD	EA	4

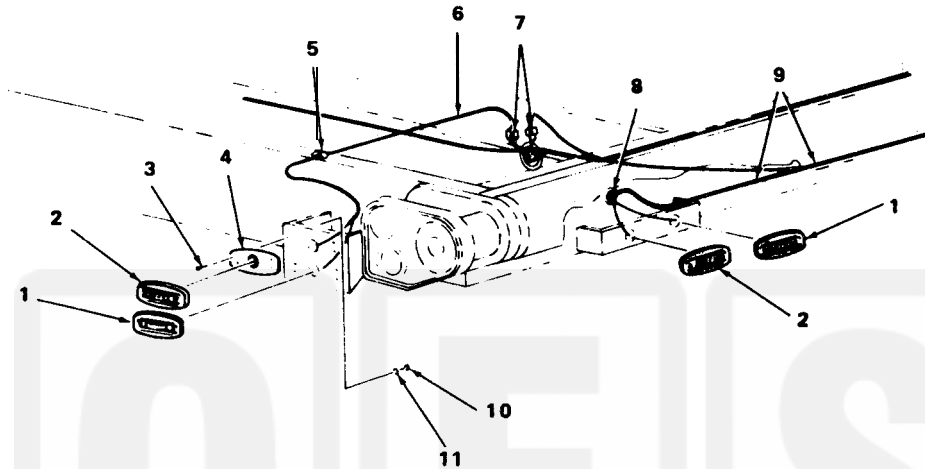

Current part is item (1) on diagram. Available at www.oshkosequipment.com



TA 031160

Figure 91. Rear wiring harness (M756A2).

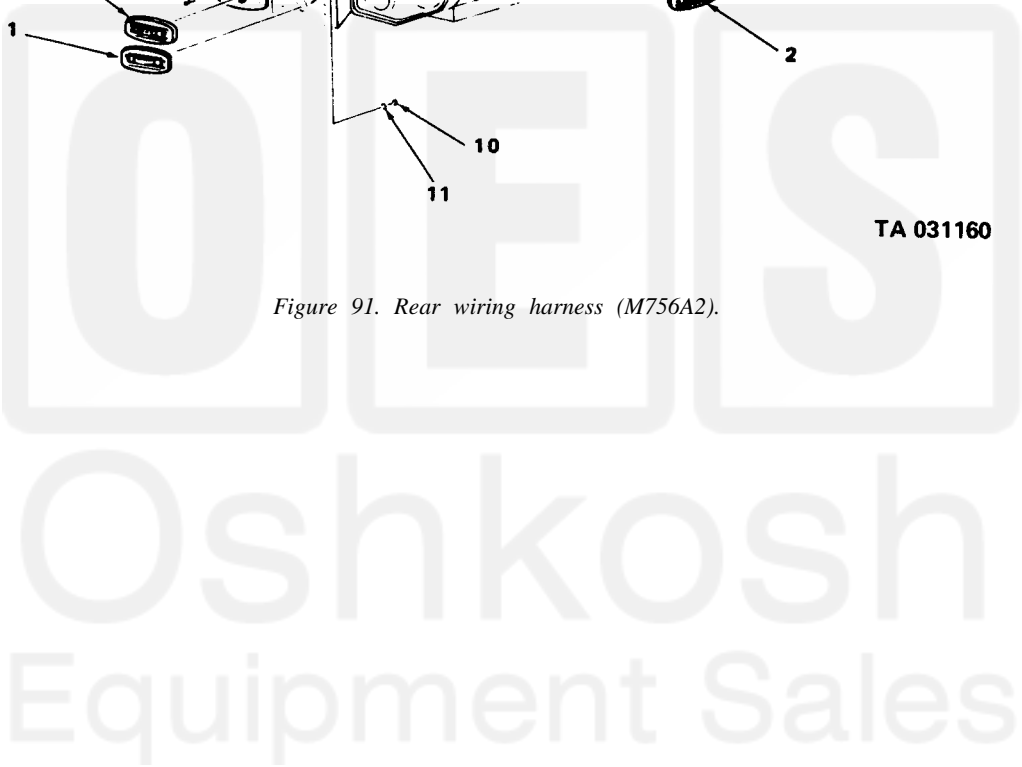

Current part is item (1) on diagram. Available at www.oshkoshequipment.com

(1) (a) FIG. NO.	(2) (b) ITEM NO.	(3) SMR CODE	(3) NATIONAL STOCK NUMBER	(4) PART NUMBER	(5) FSCM	(6) DESCRIPTION USABLE ON CODE	(7) U/M	(8) INC IN UNIT
1812-SPECIAL PURPOSE BODIES								
200	1	PAOZZ	6220-00-577-3434	MS35423-1	96906	LIGHT, MARKER, CLEARANCE: AMBER SERVICE (M292, M292A1, M292A2, M292A5)	EA	2
200	2	PAOZZ	6220-00-577-3435	MS35424-1	96906	LIGHT, MARKER, CLEARANCE: AMBER BLACKOUT 24V (M292, M292A1, M292A2, M292A5)	EA	2
200	3	PAOZZ	5999-00-057-2929	MS27148-2	96906	PIN (M292, M292A1, M292A2, M292A5)	EA	2
200	4	PAOZZ	6220-00-729-9295	MS35422-1	96906	BAND, MARKER (M292, M292A1, M292A2, M292A5)	EA	2
200	5	PAOZZ	5306-00-225-8500	MS90725-35	96906	BOLT (M292, M292A1, M292A2, M292A5)	EA	16
200	6	PAOZZ	5975-00-403-9490	8342290	19207	PLATE, WALL ELECTRICAL (M292, M292A1, M292A2, M292A5)	EA	8
200	7	PAOZZ	5930-00-259-8154	7002826	19207	SWITCH, TOGGLE: 3 WAY, CEILING (M292A1, M292A2, M292A5)	EA	8
200	8	XBOZZ		8365294	19207	CONNECTOR, RECEPTACLE: CEILING PLUG (M292, M292A1, M292A2, M292A5)	EA	8
200	9	PAOOO	6220-00-338-1086	7092284	19207	LIGHT, DOME: 110V, BLUE (M292, M292A1, M292A2, M292A5)	EA	1
200	10	PAOZZ	5305-00-855-0836	MS24615-38	96906	SCREW (M292, M292A1, M292A2, M292A5)	EA	4
200	11	PAOZZ	6220-00-025-3697	8328123	19207	LENS, DOME LIGHT: BLUE (M292, M292A1, M292A2, M292A5)	EA	1
200	12	PAOZZ	5330-00-205-0089	8328224	19207	FELT: DOME LIGHT LENS (M292, M292A1, M292A2, M292A5)	EA	1
200	13	PAOZZ	6240-00-577-3425	25AB115-125V	08805	LAMP, INCANDESCENT: ELECTRIC, 115V-125V, 25W, BLUE CEILING LIGHT, BLACKOUT (M292, M292A1, M292A2, M292A5)	EA	1
200	14	XBOZZ	5305-00-855-0836	MS24615-38	96906	SCREW (M292, M292A1, M292A2, M292A5)	EA	4
200	15	XBOZZ		7759185	19207	COVER (M292, M292A1, M292A2, M292A5)	EA	1
200	23	XBOZZ		7535635-1	19207	BOX ASSEMBLY (M292, M292A1, M292A2, M292A5)	EA	1
200	24	XBOZZ		7535637	19207	BOX ASSEMBLY (M292, M292A1, M292A2, M292A5)	EA	1
200	25	PAOZZ	2590-00-234-3248	7535639	19207	HARNESS: TELEPHONE POST (M292, M292A1, M292A2, M292A5)	EA	1
200	26	XBOZZ		7535568	19207	HARNESS (M292, M292A1, M292A2, M292A5)	EA	1
200	27	XBOZZ		7535571	19207	HARNESS (M292, M292A1, M292A2, M292A5)	EA	1
200	28	XBOZZ		7535569	19207	HARNESS (M292, M292A1, M292A2, M292A5)	EA	1
200	29	PAOZZ	2590-00-689-3385	10871777	19207	HARNESS ASSEMBLY: HEATERS TO FUEL PUMP (M292, M292A1, M292A2, M292A5)	EA	1



Current part is item (1) on diagram. Available at www.oshkoshequipment.com

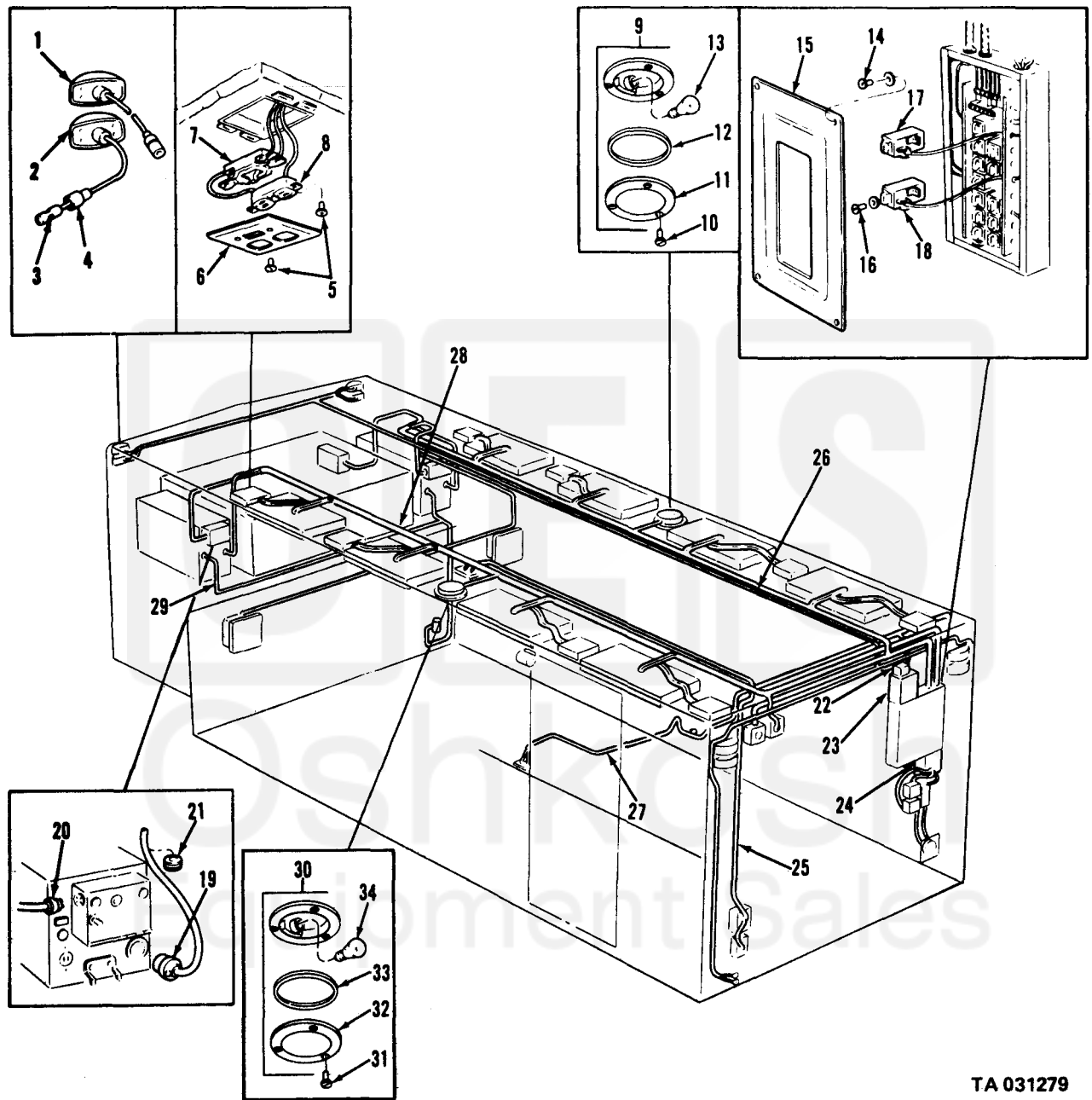

TA 031279

Figure 200. Expansible van electrical system.